

PlenumPlus™ Commercial Grade Condensate Pump

DATA SHEET

Model A2-X-1965 DV



- ◆ UL 2043 Tested
- ◆ Plenum rated
- ◆ Easy wire access
- ◆ 115/230 dual voltage, thermally protected motor
- ◆ Solid cast aluminum reservoir
- ◆ Multiple piping arrangements
- ◆ Maintenance-free ball bearing design eliminates need for lubrication

Hartell's PlenumPlus™ Commercial Grade A2-X-1965 DV has been tested to, and yielded results that fell within the acceptable criteria of UL standard 2043, Third Edition, "Fire test for heat and visible smoke release for discrete products and their accessories installed in air-handling spaces." The UL standard 2043 rating assures the PlenumPlus pump is an optimal choice for use in plenum spaces.

When safety counts, you can rely on Hartell PlenumPlus™

FEATURES:

- ◆ 1 Gallon, heavy-duty, cast aluminum reservoir
- ◆ 400 Gallons per hour max and 20 foot shut off lift
- ◆ Four outlet options: (3) 1 1/4" top inlets and (1) 3/4" fntpt at bottom of reservoir
- ◆ Maximum temperature 150 degrees
- ◆ Auxiliary safety switch
- ◆ 12-month warranty

**PLENUM
RATED**



Voltage 60 HZ	Full Load AMPS	Lift / Feet	Gallons/Liters				Feet/Meters			Dimensions			Weight
			4'	8'	12'	20'	Width	Length	Height				
115/230	3.5A or 1.7A	Gallons Per Hr	390	300	240	0	6"	9"	10"	14 lb			
		Lift / Meters	1.2 m	2.4 m	3.7 m	6 m	15.24 cm	22.86 cm	25.4 cm	6.35 kg			
		Liters Per Hour	1476.3	1135.6	908	0							

Tel: 215.322.0730 • Fax: 800.322.5519 • www.hartell.com • info@hartell.com



DATA SHEET

PlenumPlus™ Commercial Grade Condensate Pump

Model A2-X-1965 DV

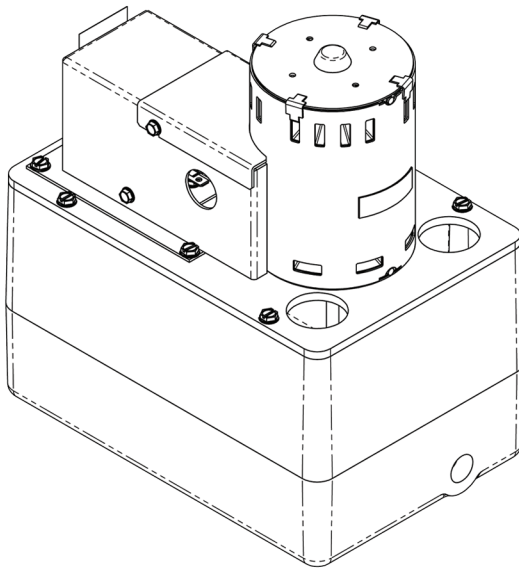

**PLENUM
RATED**

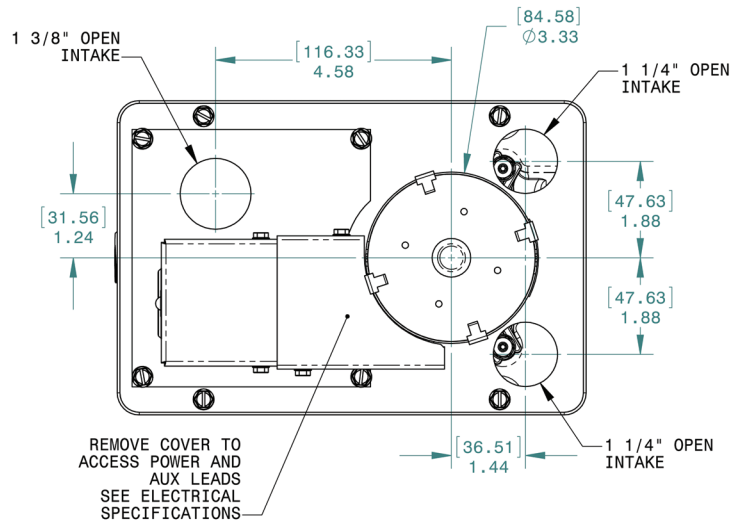

TOP VIEW

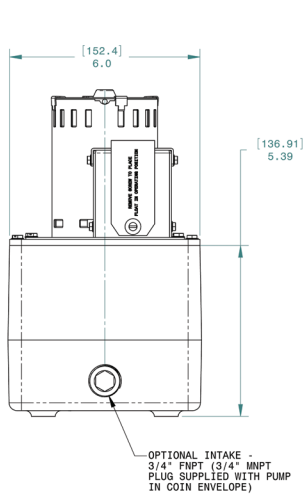

OPTIONAL INLET END VIEW

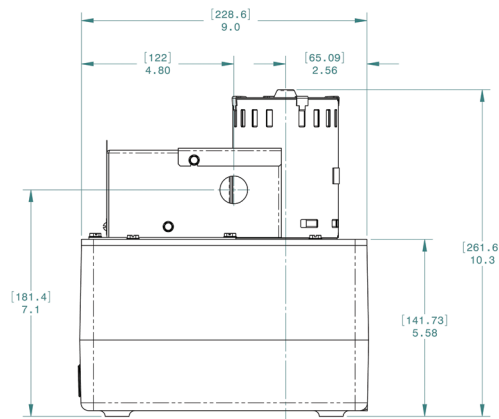

SIDE VIEW

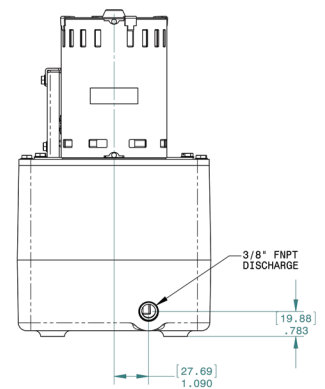

DISCHARGE END VIEW